

CODE	BOTANICAL NAME	COMMON NAME	QUANTITY	SIZE	SPACING	COMMENTS
Trees						
AG	Acer Griseum	Lace Bark Maple	3	10'-12' HT	SEE PLAN	B&B Multi Stem
BN	Betula nigra 'Heritage'	River Birch 'Heritage'	13	14'-16' HT	SEE PLAN	B&B Multi Stem Spring plant only
CC	Cercis canadensis	Eastern redbud	3	10'-12' HT	SEE PLAN	B&B Multi Stem
CF	Cornus Florida	Flowering Dogwood	4	2'-12" - 3' Cal	SEE PLAN	B&B
CJ	Cryptomeria japonica	Japanese Cryptomeria	3	6'-8' HT	SEE PLAN	B&B
CL	Cupressocyparis leylandii	Leyland Cypress	7	11'-12' HT	SEE PLAN	B&B
GT	Gleditsia truncanthos var. inermis 'Skyline'	Skyline Thornless Honeylocust	20	3' - 3 1/2'	SEE PLAN	B&B
FS	Fagus sylvatica	European Beech	1	4' - 4 1/2' Cal	SEE PLAN	B&B
LT	Liriodendron tulipifera	Tulip Tree	3	4' - 4 1/2' Cal	SEE PLAN	B&B
MG	Metasequoia glyptostrobodes	Dawn Redwood	1	14'-16' HT	SEE PLAN	B&B
MS	Magnolia stellata 'carterianae'	Star magnolia	3	10'	SEE PLAN	B&B Multi Stem
MV	Magnolia virginiana	Sweetbay Magnolia	1	10' HT	SEE PLAN	B&B
NS	Nyssa sylvatica	Black Gum Tupelo	10	3' - 3 1/2' Cal	SEE PLAN	B&B
PO	Picea omorika	Siberian Spruce	12	11'-12' HT	SEE PLAN	B&B
QP	Quercus phellos	Willow Oak	2	4' - 4 1/2' Cal	SEE PLAN	B&B
TO	Thuja occidentalis 'Emerald Green'	Eastern arborvitae	8	5'-6' HT	SEE PLAN	B&B
ZS	Zelkova serrata 'Green Vase'	Japanese Zelkova	16	3' - 3 1/2' Cal	SEE PLAN	B&B
Shrubs						
CA	Cornus alba 'Bailhato'	Ivory Halo Tartarian Dogwood	22	30-36"	SEE PLAN	B&B
CZ	Cornus alba	Tartarian Dogwood	14	30-36"	SEE PLAN	B&B
HA	Hydrangea aborescens 'Annabelle'	Annabelle hydrangea	22	30-36"	SEE PLAN	B&B
HQ	Hydrangea quercifolia	Oakleaf hydrangea	18	30-36"	SEE PLAN	B&B
PL	Prunus laurocerasus 'Oto Layken'	Oto Layken Cherry Laurel	198	36"	SEE PLAN	B&B
RC	Rhododendron catawbiense	Catawba Rhododendron	13	30-36"	SEE PLAN	B&B
Grasses						
CR	Carex conica	Variagated Sedge	5	1 gal	SEE PLAN	Cont.
HE	Helictotrichon sempervirens	Blue Oat Grass	92	3 gal	SEE PLAN	Cont.
MC	Muhlenbergia capillaris	Pink Hair Grass	26	3 gal	SEE PLAN	Cont.
MP	Miscanthus sinensis var. purpurascens	Flame Grass	24	3 gal	SEE PLAN	Cont.
PS	Pennisetum setaceum 'Rubrum'	Purple Fountain Grass	14	3 gal	SEE PLAN	Cont.
Perennials						
AN	Athyrium niponicum 'pictum'	Japanese Painted Fern	890	1 gal	18" O.C.	Cont.
HHR	Hemerocallis 'Happy Returns'	Happy Returns Day Lily	353	1 gal	18" O.C.	Cont.
HS	Hemerocallis 'Stella d'Oro'	Stella D'Oro Day Lily	343	1 gal	18" O.C.	Cont.
HWF	Hosta subcordata 'Frances Williams'	Frances Williams Hosta	11	1 gal	18" O.C.	Cont.
HV	Hosta ventricosa	Blue/P/ lantern Lily	12	1 gal	18" O.C.	Cont.
IG	Iris germanica 'Zebray'	Bearded iris	53	1 gal	18" O.C.	Cont.
LM	Liriope muscari 'Majestic Blue'	Majestic Blue Lily Turf	1389	1 gal	18" O.C.	Cont.
LMV	Liriope muscari 'Variegata'	Variagated Liriope	501	1 gal	18" O.C.	Cont.
PAL	Perovskia atriplicifolia 'Little Spire'	Little Spire Russian Sage	61	3 gal	30" O.C.	Cont.

General Landscape Notes:

- All plant material shall conform to the American Association of Nurseryman Standards.
- Additional plant material may be installed on site by Owner in accordance with the Township landscape standards.
- All plant material shall be maintained in a healthy and growing condition, and replaced with plant material of similar variety and size if damaged, destroyed or removed.
- Landscape areas shall be kept free of trash, litter and weeds.
- All landscape areas shall be protected from vehicular traffic through the use of concrete curbs, wheel stops or other permanent barriers.
- All landscape areas shall be constructed, installed and maintained so as not to obstruct view of motorists between the street and access drives.
- Accept areas noted for sod, all disturbed permeable surfaces not occupied by trees, shrubs, planting beds, signs, and other permitted items or features shall receive minimum 4" topsoil and be reseeded with specified lawn mixture. All shrub beds and tree saucers shall be mulched as detailed. See civil drawings for Limit of Work.
- Landscape Contractor is responsible for verification of all plant quantities.
- Full bed preparation typical.
- Landscape Contractor to provide a unit cost (including installation) for ALL items.
- Verify location of all utility lines prior to installation. Field adjustment for general intent if conflict exists.
- When the same species of trees are paired or grouped in 3 or more, they should be matched in size, shape, growth characteristics, etc.
- Project Landscape Architect shall tag all trees at nursery.
- Landscape Contractor is responsible for the calculation of all sod/irrigation & hydromulch quantities.
- Landscape Contractor is responsible for all watering operations for two months after owner acceptance.
- Plant material availability shall be confirmed by Landscape Contractor prior to bidding. Should specified material not be available, the Landscape Architect and Owner shall be notified prior to bid date.
- Landscape Contractor shall not eliminate, substitute, and/or downsize plant material without prior approval of Owner and Landscape Architect. Minimum standards and requirements of the Township Landscape Submittal plan must be maintained.
- Plant substitutions may only be made if a plant becomes unavailable. Substitutions will not be permitted unless substantiated written proof is supplied that a specified plant is not obtainable. In this situation a plant can only be submitted by a plant of similar size, habitat, and value. Absolutely no substitutions can be made without the approval of the project Landscape Architect.
- All planting areas use 3" of shredded Cedar Bark Mulch.
- All Betula nigra should be installed during the Spring planting season only.
- Landscape Contractor to verify all landscape plant quantities. Landscape contractor is responsible for all final tree shrubs and ground cover quantities as drawn on plan - drawing takes precedence over legend and quantities on plant call out tags in case of discrepancies.
- See Civil Drawings for existing tree protection.
- See Civil Drawings for limit of work.
- Planter tree well mulch to be 3" depth Crushed Linwood Granite from Kafka Granite (www.kalkagrante.com)

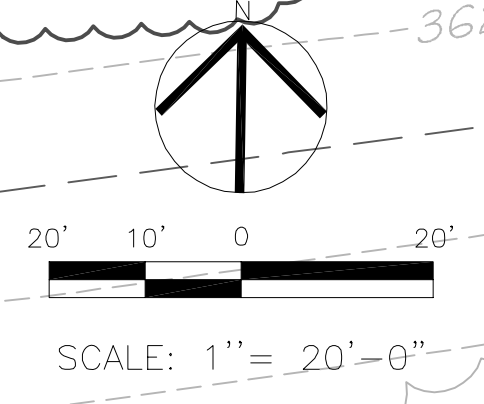

© 2005 Burt Hill Inc.
 Seal
 100% Construction Document Set

DELAWARE COUNTY COMMUNITY COLLEGE
 NEW S.T.E.M. COMPLEX - TECHNOLOGY BUILDING AND SITEWORK

901 Media Line Rd.
 Media, PA 19063

Revisions

No.	Date	By	Description
1	12-10-2007		
2	12-18-2007		

Date November 21, 2007

Drawing Name

Project Number 0790400

Drawing Number